



Sutherland Avenue, Bexhill-On-Sea TN39 3QR

Offers in excess of £895,000



6



3



4



Situated on a tree-lined road in Collington, close to Bexhill-on-Sea and Collington railway station, this FIVE/SIX BEDROOM house has been thoughtfully extended and reworked to create a flexible, easy-going family home, with the added benefit of a SELF-CONTAINED ANNEXE.

You enter through a porch into a welcoming hallway, at the back of the house the OPEN-PLAN KITCHEN AND DINING ROOM spans the width of the property, with BI-FOLDING FRENCH DOORS that open straight onto the garden and bring in plenty of natural light, creating a sense of indoor/outdoor living. The kitchen is centred around an island with a breakfast bar and an adjoining utility room.

GROUND FLOOR
2136 sq.ft. (198.4 sq.m.) approx.

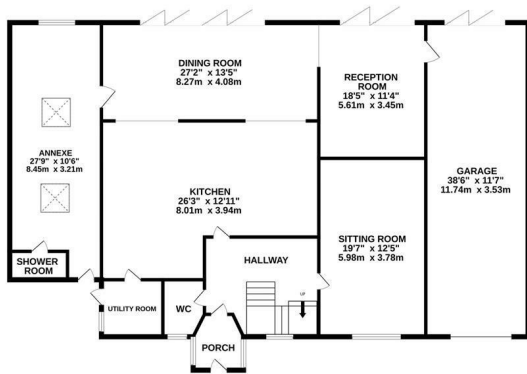

1ST FLOOR
1240 sq.ft. (115.2 sq.m.) approx.

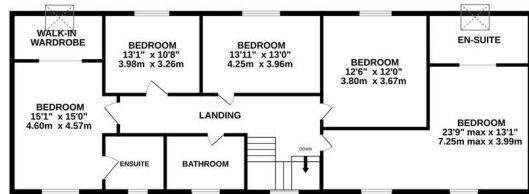

TOTAL FLOOR AREA: 3375 sq.ft. (313.6 sq.m.) approx.

Whilst every attempt has been made to ensure the accuracy of the floorplan contained here, measurements of doors, windows, rooms and any other items are approximate and no responsibility is taken for any error, omission or mis-statement. This plan is for illustrative purposes only and should be used as such by any prospective purchaser. The services, systems and appliances shown have not been tested and no guarantee as to their operability or efficiency can be given.
Made with Metropix ©2026

